



## Catalog sheet

### STB 005 Self-closing, push-button, concealed shower mixer with adjustable water temperature

### STB 006 Self-closing, push-button, concealed shower mixer with mounting box as adjustable water temperature

Self-closing, push-button, concealed shower mixer with adjustable water temperature via a separate valve. Opening time 15-25 s, Water temperature 5-70°C, Flow rate 15 l/min (3 bar), Min. 0.5 bar; Max. 6 bar; recommended 2-4 bar

The faucets have a continuously adjustable flow time of 15-25 seconds, after which the water flow automatically stops, so they do not require any power supply.

This type of battery is highly resistant to mechanical damage and wear. It is mainly used in public areas – such as swimming pools, public baths, campsites, etc.

For maintenance, we recommend using LARRIN cleaning agent.

#### Complete delivery

- Push-button faucet body
- Cover plate

#### Standard versions

- STB 005 Self-closing, push-button, concealed shower mixer with adjustable water temperature via a separate valve
- STB 006 Self-closing, push-button, concealed shower mixer with mounting box, with adjustable water temperature via separate valve

#### Technical details

- Opening time 15-25 s
- Water temperature 5-70°C
- Flow rate 10 l/min (3 bar)
- Min. 0.5 bar; Max. 6 bar; recommended 2-4 bar

#### Construction readiness requirements

- Water inlet G1/2" prepared according to the diagram
- Prepared niche corresponding to the dimensions of the battery



STB 005



STB 006



## Diagram

STB 005

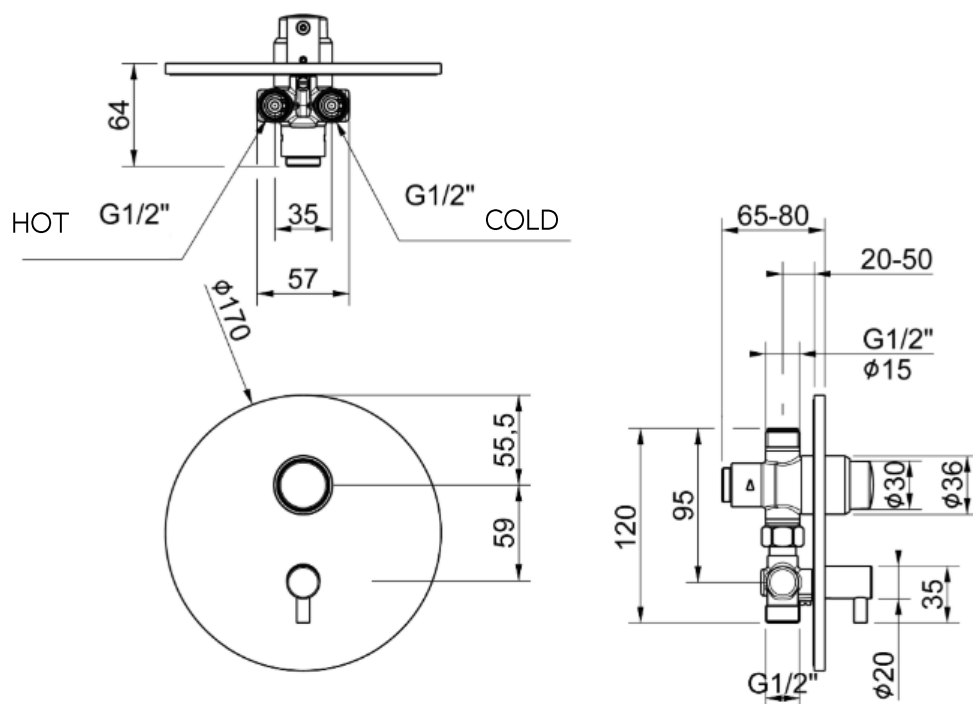

STB 006

